

SPECIFICATIONS &
FUNCTIONALITY

MECHANISMS

FOR CHAIRS
OF NOWY STYL GROUP

PERMANENT CONTACT MECHANISM

CPT

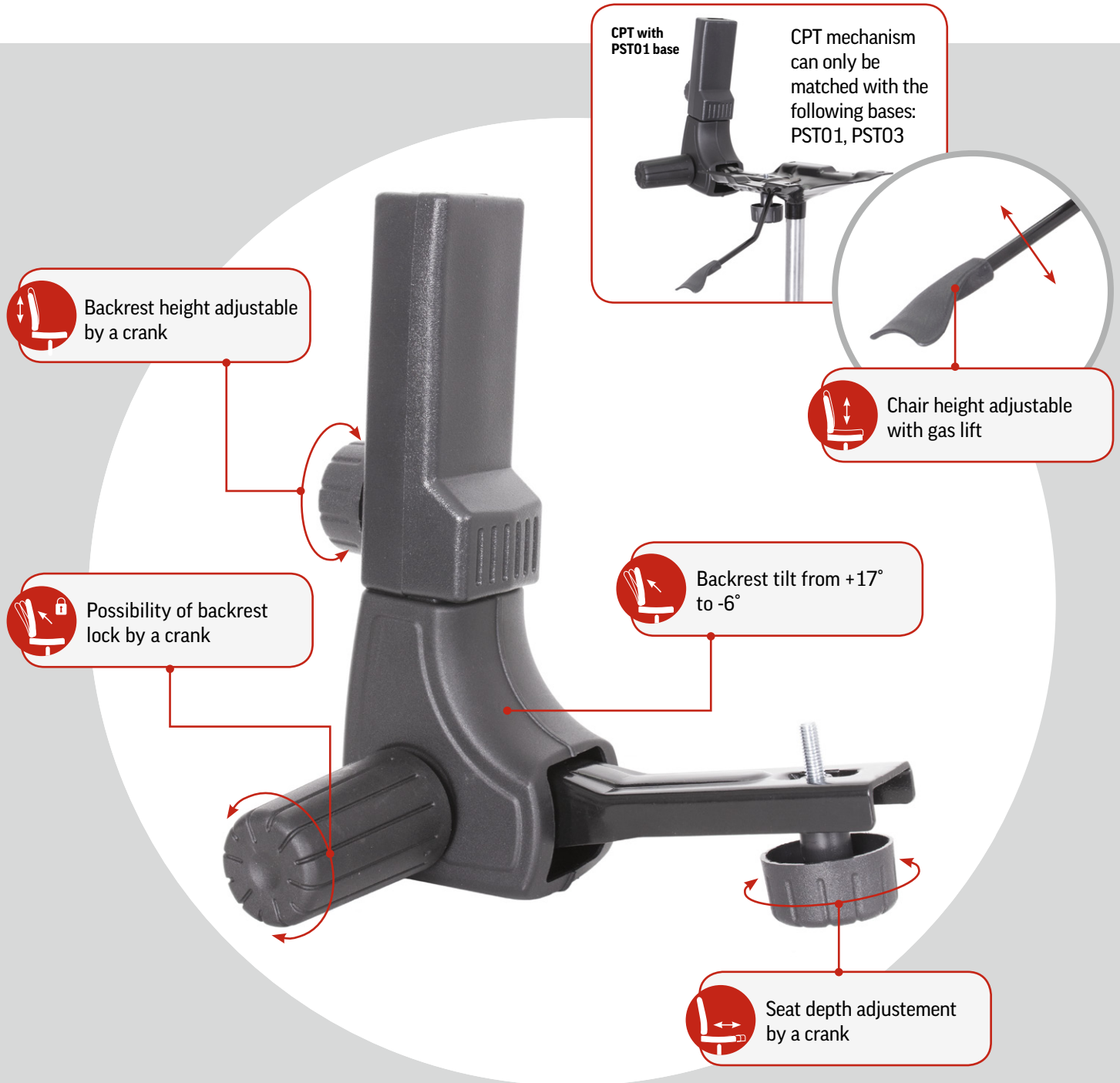

CPT with PST01 base

CPT mechanism can only be matched with the following bases: PST01, PST03

Backrest height adjustable by a crank

Chair height adjustable with gas lift

Backrest tilt from +17° to -6°

Possibility of backrest lock by a crank

Seat depth adjustment by a crank



According to Environmental Product Declaration, this mechanism is 99% recyclable.

Examples of chairs with CPT mechanism



Smart



T-bar



Mind



Prestige



Ministyle

PERMANENT CONTACT MECHANISM

KONTAKT

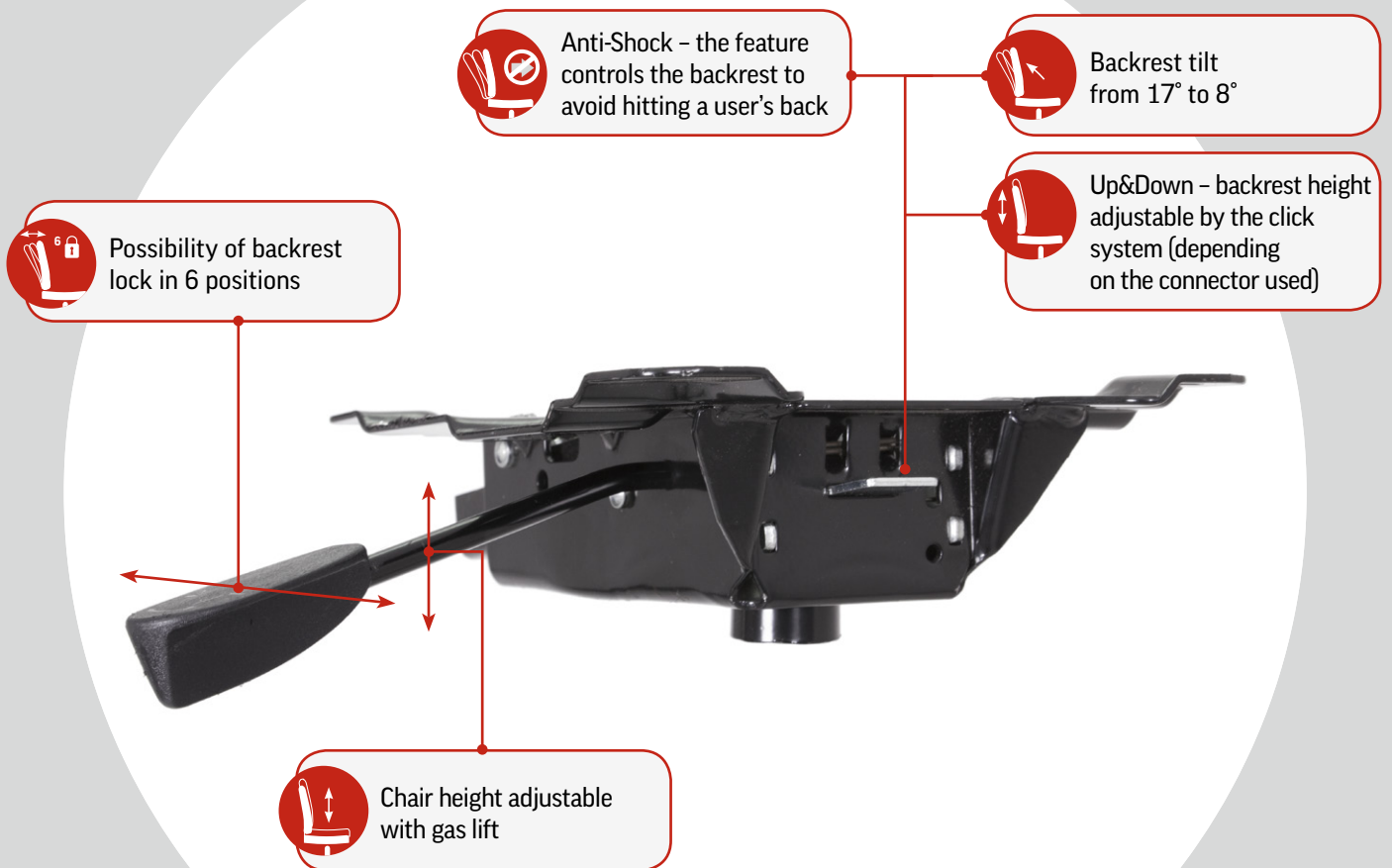

According to Environmental Product Declaration, this mechanism is 99% recyclable.

Examples of chairs with KONTAKT mechanism



Webst@r



Master



Webst@r



Master

PERMANENT CONTACT MECHANISM

ERGON 2L



According to Environmental Product Declaration, this mechanism is 99% recyclable.

Examples of chairs with ERGON 2L mechanism



I-line



Punkt



Reflex



Taktik

ASYNCHRONOUS MECHANISM

ERGON UP



According to Environmental Product Declaration, this mechanism is 99% recyclable.

Examples of chairs with ERGON UP mechanism



Taktik



Drop

ASYNCHRONOUS MECHANISM

IBRA



According to Environmental Product Declaration, this mechanism is 99% recyclable.

Examples of chairs with IBRA mechanism



Labo



XL Pro



Offix



XL Pro



Offix

ASYNCHRONOUS MECHANISM

SELF (S1D)



According to Environmental Product Declaration, this mechanism is 99% recyclable.

ASYNCHRONOUS MECHANISM

SELF PLUS



According to Environmental Product Declaration, this mechanism is 99% recyclable.

SYNCHRONOUS MECHANISM

ACTIVE 1



According to Environmental Product Declaration, this mechanism is 99% recyclable.

i **Active** and **Active IN** mechanisms are interchangeable. However, due to the differences in the dimensions, testing must be performed to determine whether the change can be made.

Examples of chairs with ACTIVE 1 mechanism



Quatro



Master



Stillo



Intrata



Roxy

SYNCHRONOUS MECHANISM

ACTIVE IN (AN)

Up&Down - backrest height adjustable by the 10 clicks system

Seating comfort improvement, by pushing away the mounting gas lift socket from the screw that adjusts the backrest tilt force.

Active IN Active 1

Synchronous tilting of the backrest 20° and seat 8°

Anti-Shock - the feature controls the backrest to avoid hitting a user's back

Free floating seat and backrest

Backrest and seat inclination lockable in 5 positions

Chair height adjustable with gas lift

Backrest tilt force adjustable by a crank

Active IN mechanism is an improved version of **Active 1**. **Active 1** and **Active IN** mechanisms are interchangeable. However, due to the differences in the dimensions, testing must be performed to determine whether the change can be made.

According to Environmental Product Declaration, this mechanism is 99% recyclable.

Examples of chairs with ACTIVE IN mechanism



Quatro



Master



Stillo



Intrata



Roxy

SYNCHRONOUS MECHANISM

TILT



According to Environmental Product Declaration, this mechanism is 99% recyclable.

Examples of chairs with TILT mechanism



Madame



Amadeus



Mirage



Feniks



Nadir

SYNCHRONOUS MECHANISM

TLM



According to Environmental Product Declaration, this mechanism is 99% recyclable.

SYNCHRONOUS MECHANISM

IMARC 660

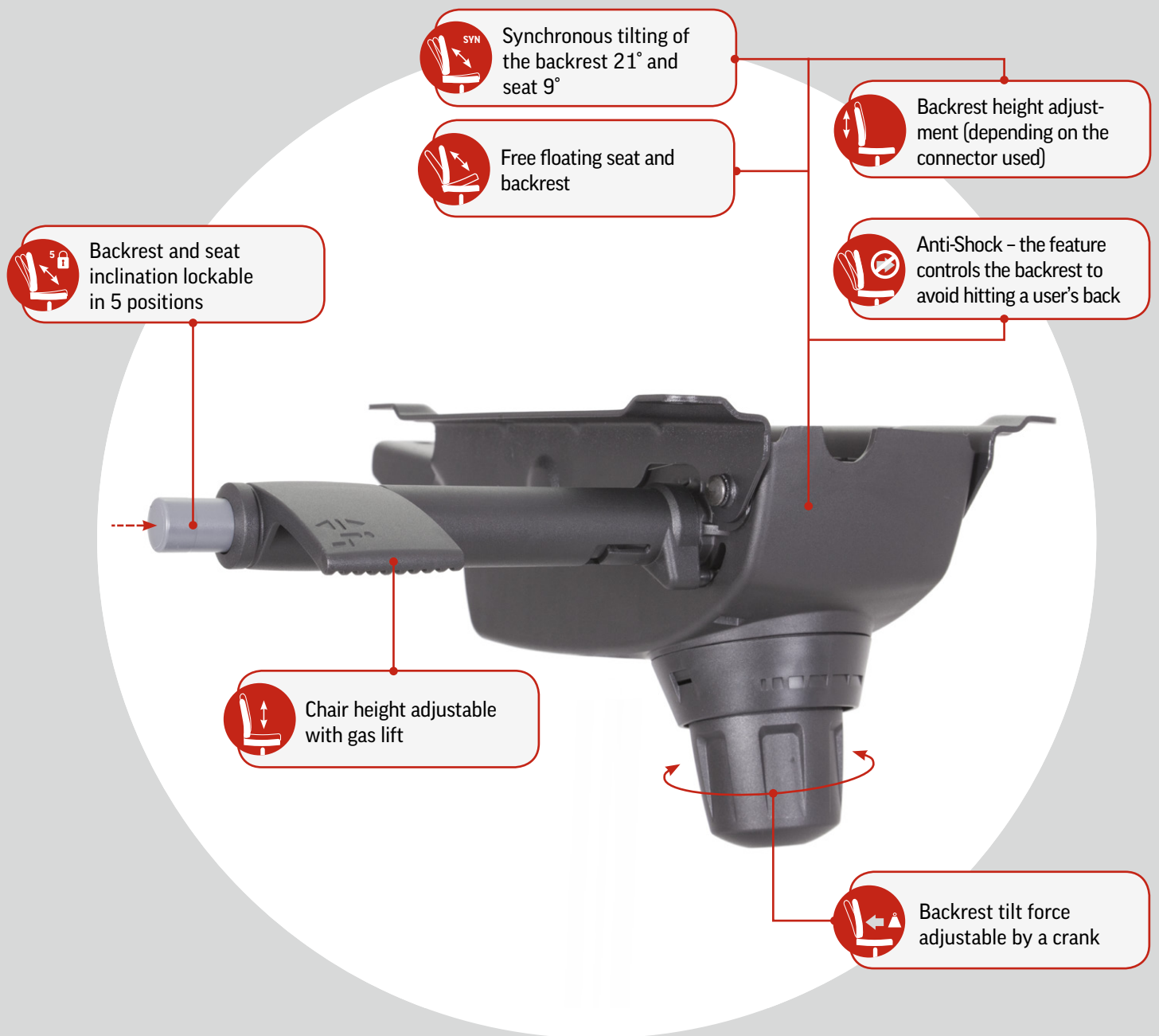

According to Environmental Product Declaration, this mechanism is 99% recyclable.

Examples of chairs with IMARC 660



Offix



Roxy



Mind



T-Bar

SYNCHRONOUS MECHANISM

IMARC 840/670

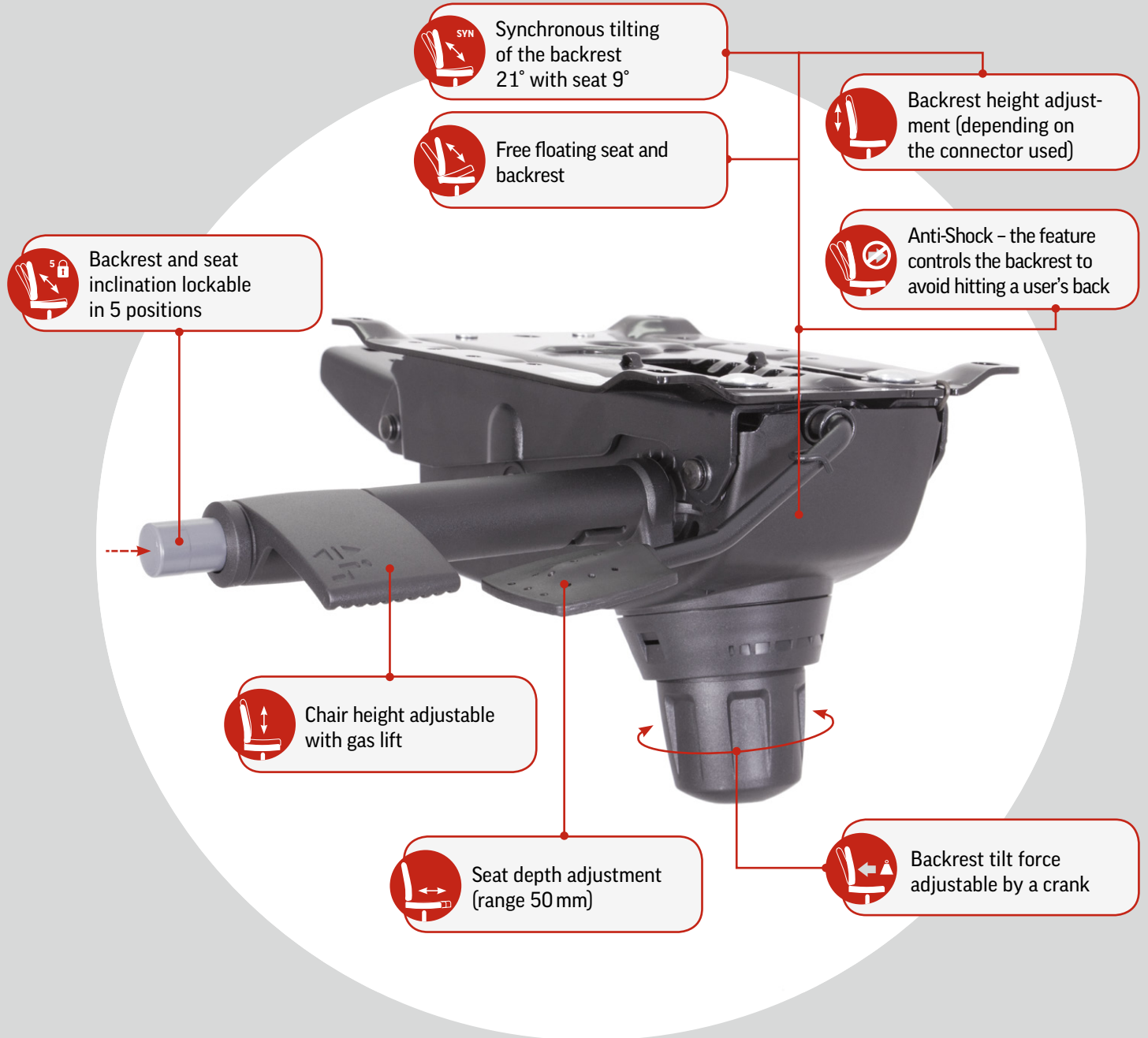

According to Environmental Product Declaration, this mechanism is 99% recyclable.

IMARC 670 is a more cost effective version of 840 due to the materials used in production.

Examples of chairs with IMARC 840/670 mechanism



Hype



Hype



Roxy



Master



T-Bar

SYNCHRONOUS MECHANISM

MULTIBLOCK MPD-170 / MULTIBLOCK MPD-165



According to Environmental Product Declaration, this mechanism is 99% recyclable.



Mechanism **MULTIBLOCK MPD-165** (7.8) has all the features of MPD-170 + stronger spring.

Examples of chairs with MULTIBLOCK MPD-170 / MULTIBLOCK MPD-165 mechanism



Rhapsody



Lynx



Formula



Spark



Elf

SYNCHRONOUS MECHANISM

MPD 165 SYNCRON

Duetto



According to Environmental Product Declaration, this mechanism is 99% recyclable.

Examples of chairs with MPD 165 SYNCRON mechanism



Linea



Formula



Nova Star



Sonata



Neo

SYNCHRONOUS MECHANISM

MPD-38



According to Environmental Product Declaration, this mechanism is 99% recyclable.



MPD-38 mechanism is a more cost effective version of **MPD-170** while maintaining the same features.

Examples of chairs with MPD-38 mechanism



Neo



Carera



Orion

SYNCHRONOUS MECHANISM

TATTO



seat height

Chair height adjustable with gas lift

Synchronous tilting of the backrest 20,5° and seat 6,5°

Free floating seat and backrest

Up&Down – backrest height adjustment (depending on the connector used)

Anti-Shock – the feature controls the backrest to avoid hitting a user’s back

Backrest tilt force adjustable by a crank

body weight

back angle

Backrest and seat inclination lockable in 4 positions



According to Environmental Product Declaration, this mechanism is 99% recyclable.

Examples of chairs with TATTO mechanism



Jump



Jump

SYNCHRONOUS MECHANISM

EPRON SYNCRON (ES)

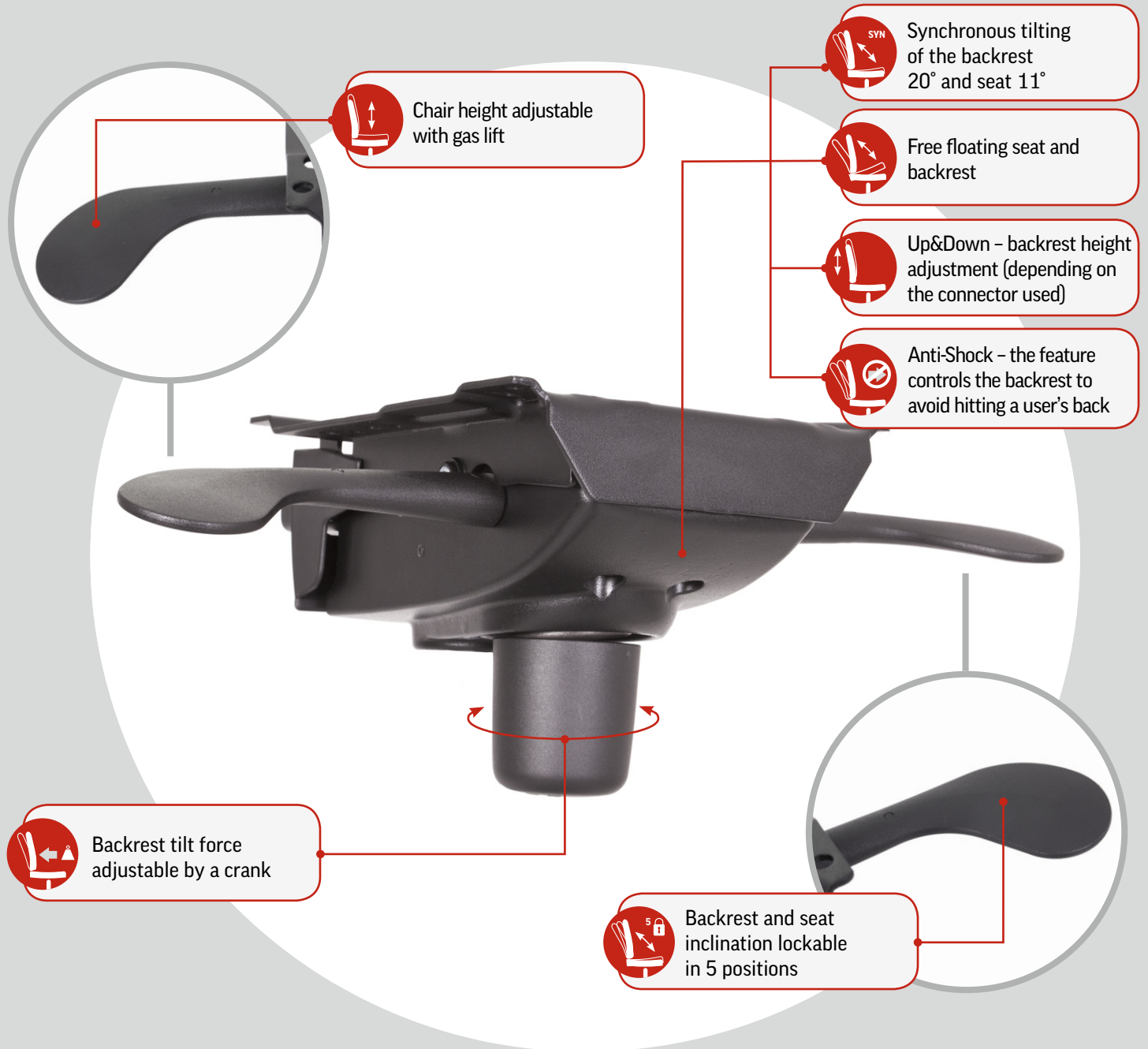

According to Environmental Product Declaration, this mechanism is 99% recyclable.

Examples of chairs with ES mechanism



Intrata



Orlando



Officer-Net



Sit.On



Chester

SYNCHRONOUS MECHANISM

EPRON SYNCRON Trasla (EST)

with seat depth adjustment

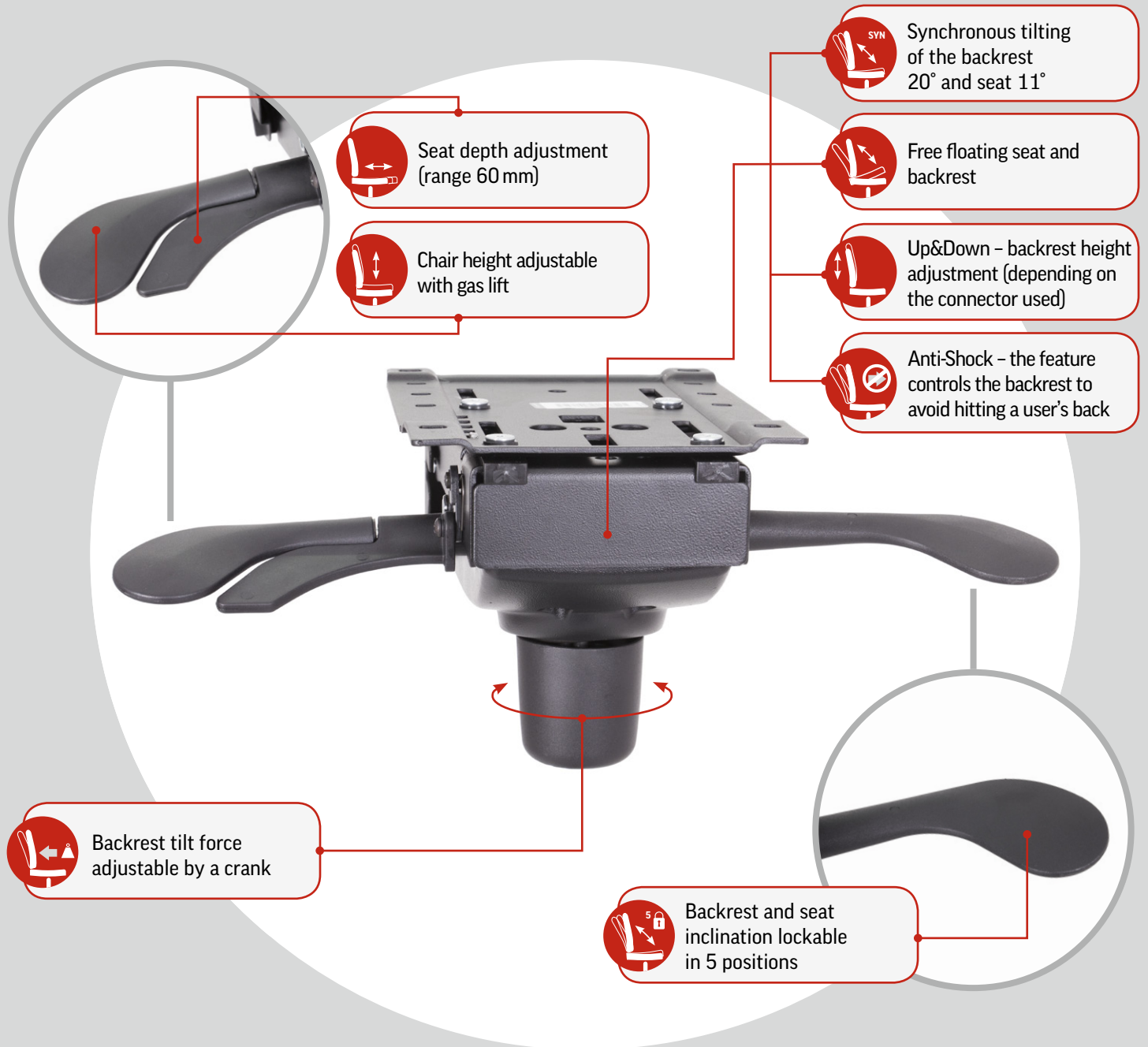

According to Environmental Product Declaration, this mechanism is 99% recyclable.

Examples of chairs with EST mechanism



Jump



Chester



Sit.Net



Sonata



@-motion

SYNCHRONOUS MECHANISM

EPRON Flex Trasla (EFT)

with seat depth adjustment and negative seat inclination



According to Environmental Product Declaration, this mechanism is 99% recyclable.

Examples of chairs with EFT mechanism



Z-body



Orlando



Master



Kubik



@-motion

SYNCHRONOUS MECHANISM

EPRON SYNCRON PLUS (ESP)

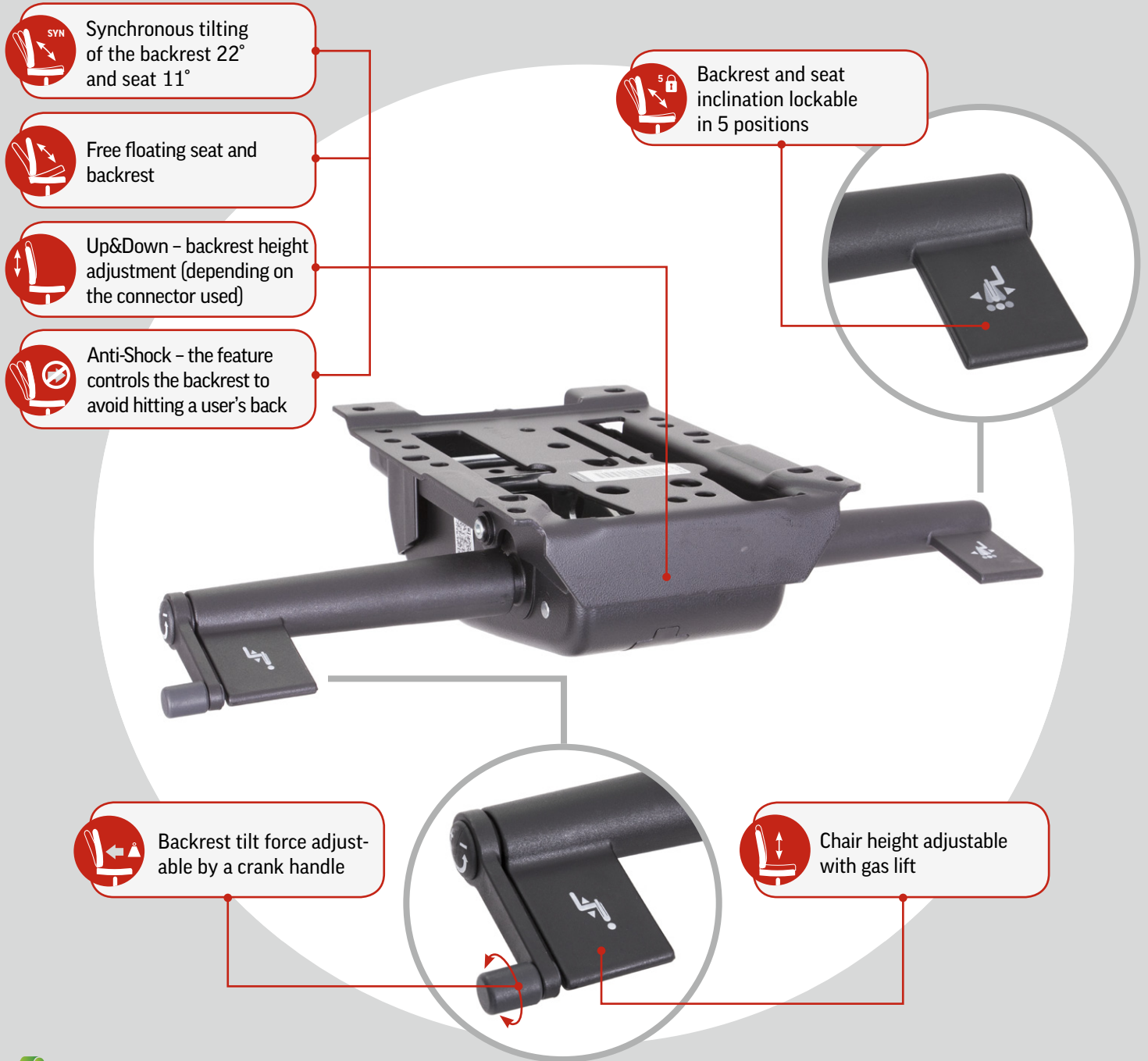

According to Environmental Product Declaration, this mechanism is 99% recyclable.

Examples of chairs with ESP mechanism



Montana



Next-U



4ME



Z-body



Invitus

SYNCHRONOUS MECHANISM

EPRON SYNCRON PLUS Trasla (ESPT)

with seat depth adjustment



According to Environmental Product Declaration, this mechanism is 99% recyclable.

Examples of chairs with ESPT mechanism



Intrata



Next-U



Z-Body



Orlando



Montana

SYNCHRONOUS MECHANISM

EPRON SYNCRON PLUS Negative (ESPN)

with negative seat inclination

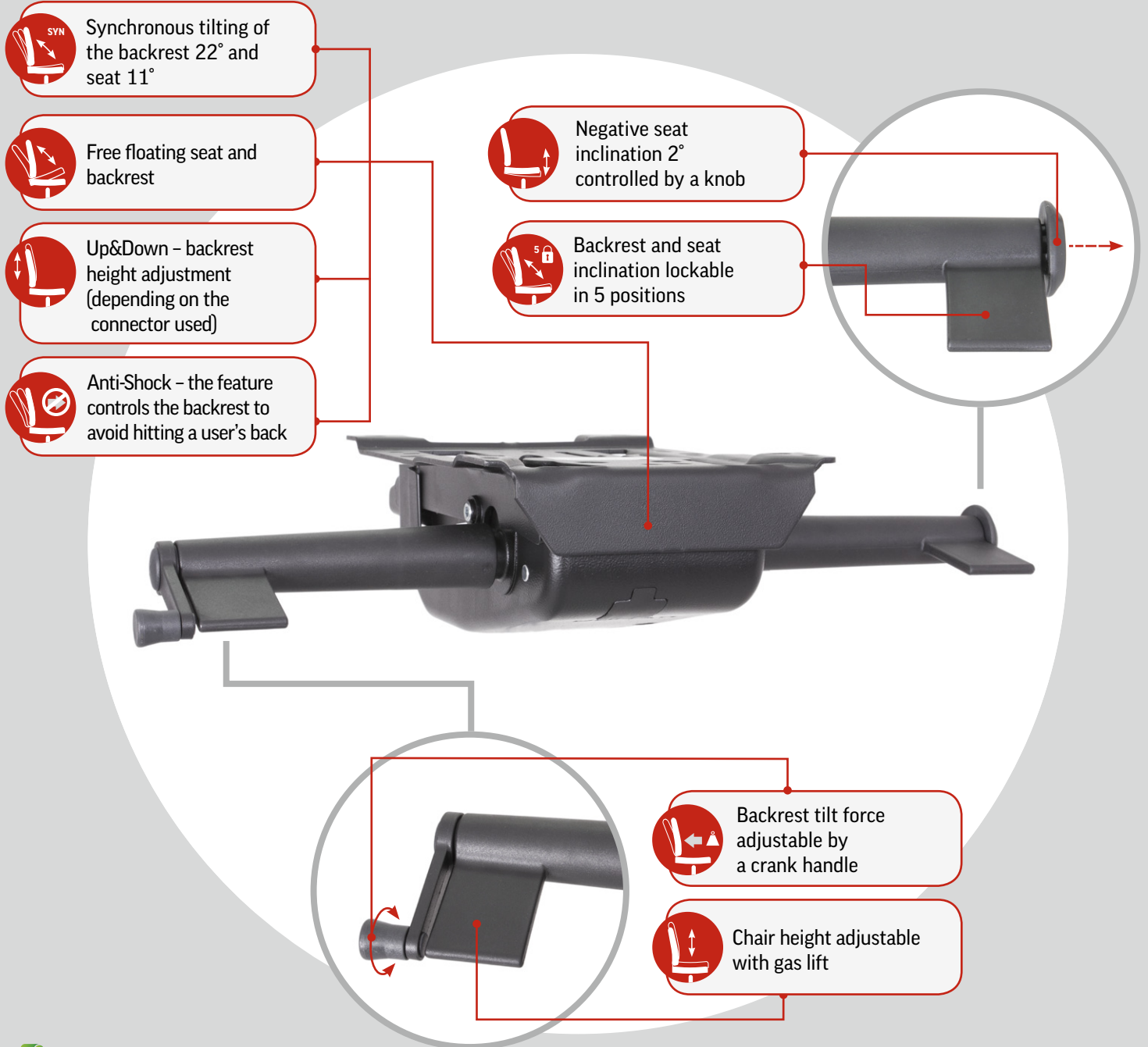

According to Environmental Product Declaration, this mechanism is 99% recyclable.

Examples of chairs with ESPN mechanism



Montana



Next-U



4ME



Z-body



Invitus

SYNCHRONOUS MECHANISM

EPRON SYNCRON PLUS Trasla Negative (ESPTN)

with seat depth adjustment and negative seat inclination

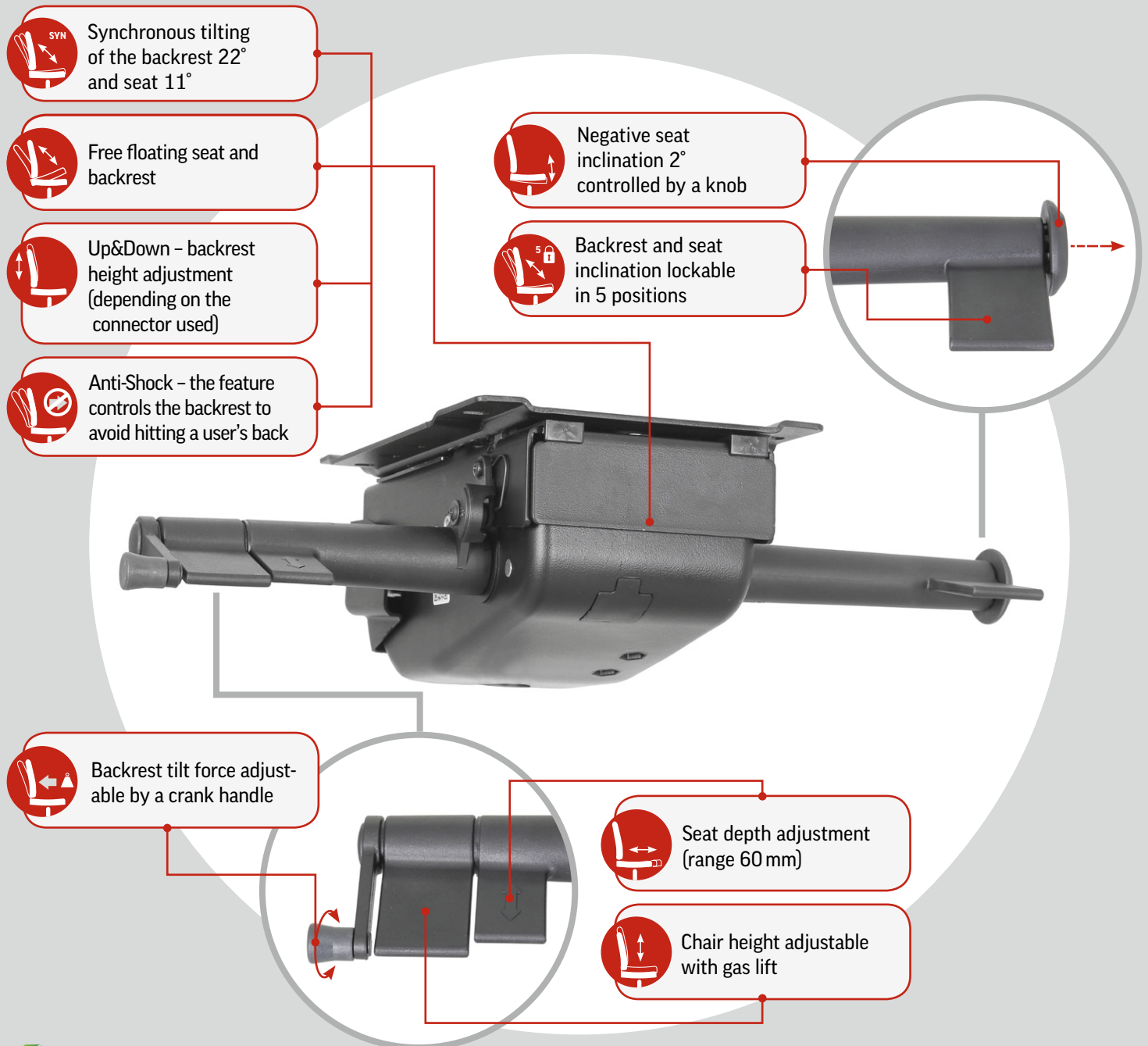

 According to Environmental Product Declaration, this mechanism is 99% recyclable.

Examples of chairs with ESPTN mechanism



Intrata



Next-U



Z-Body



Intrata



Invitus

SYNCHRONOUS MECHANISM TENSION (TNT)



According to Environmental Product Declaration, this mechanism is 99% recyclable.

Tension Synchron mechanism has all the features of **Tension** mechanism, except of seat depth adjustment.

Examples of chairs with TENSION mechanism



Intrata



Trinity

SYNCHRONOUS MECHANISM

REVO NEW*



Synchronous tilting of the backrest 21° and seat 10°



Free floating seat and backrest



Anti-Shock - the feature controls the backrest to avoid hitting a user's back



Backrest and seat inclination lockable in 5 positions

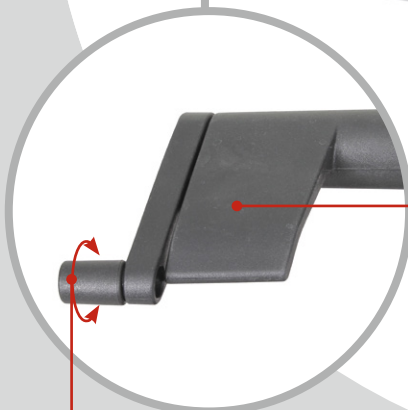

Chair height adjustable with gas lift



Backrest tilt force adjustable by a crank handle (45 kg - 110 kg)



According to Environmental Product Declaration, this mechanism is 99% recyclable.

* New mechanism, available from April 2014.

SYNCHRONOUS MECHANISM

REVO NEW TRASLA*

with seat depth adjustment

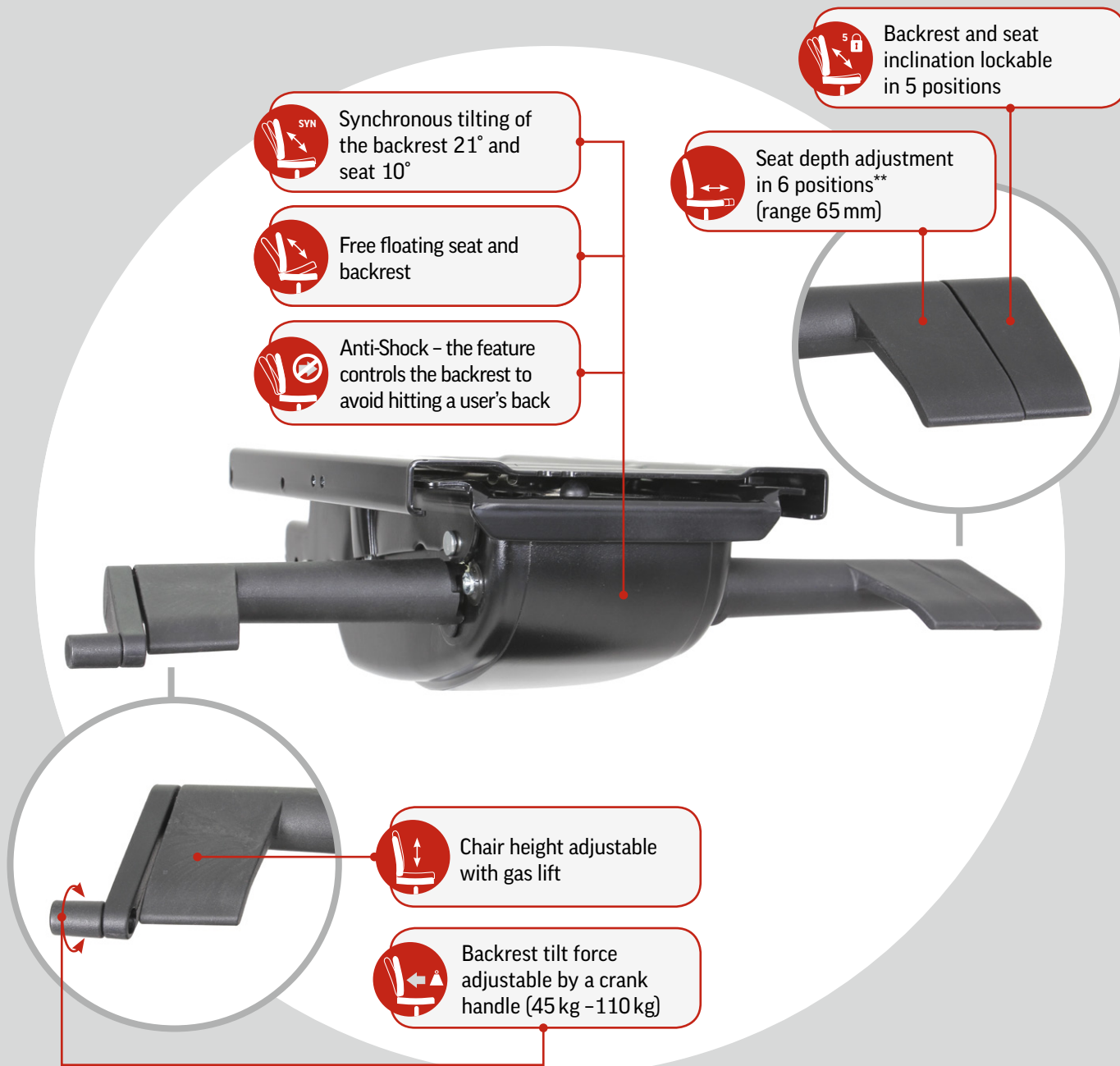

According to Environmental Product Declaration, this mechanism is 99% recyclable.

* New mechanism, available from April 2014.
** Lockable in 5 positions (range 50 mm) in case of BELITE chair.

SYNCHRONOUS MECHANISM

LP01 STANDARD FLEX*



According to Environmental Product Declaration, this mechanism is 99% recyclable.

* No longer available as of 2015. Will be replaced by **Revo New Standard Flex** mechanism.

Examples of chairs with LP01 STANDARD FLEX mechanism



Belite



Extra Mesh 8



Belite



Extra Mesh 8

SYNCHRONOUS MECHANISM

LP01 TRASLA FLEX*

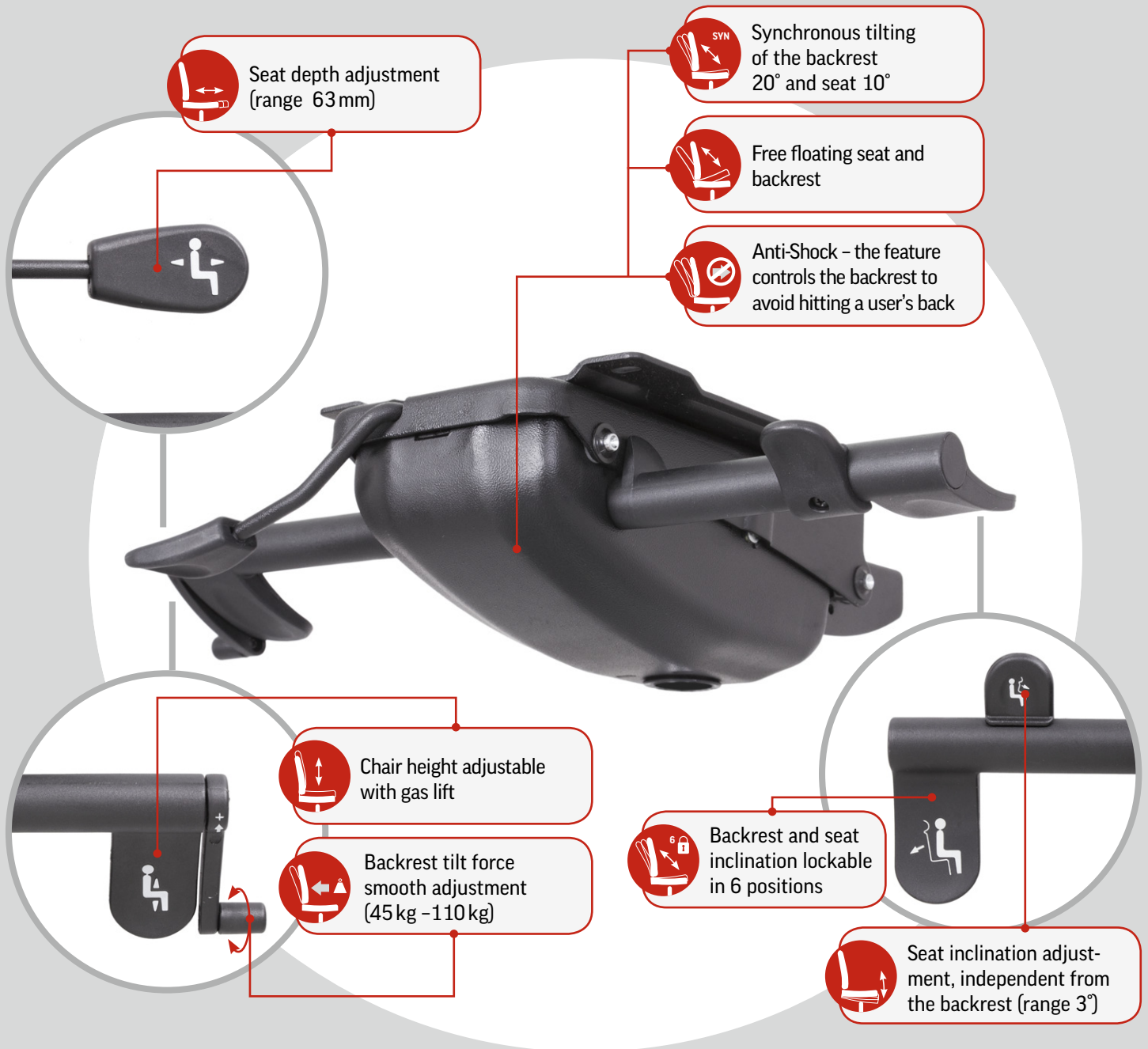

According to Environmental Product Declaration, this mechanism is 99% recyclable.

* No longer available as of 2015. Will be replaced by **Revo New Trasla Flex** mechanism.

Examples of chairs with LP01 TRASLA FLEX mechanism



Belite

Extra Mesh 8

Belite

Extra Mesh 8

SYNCHRONOUS MECHANISM

REVO STANDARD

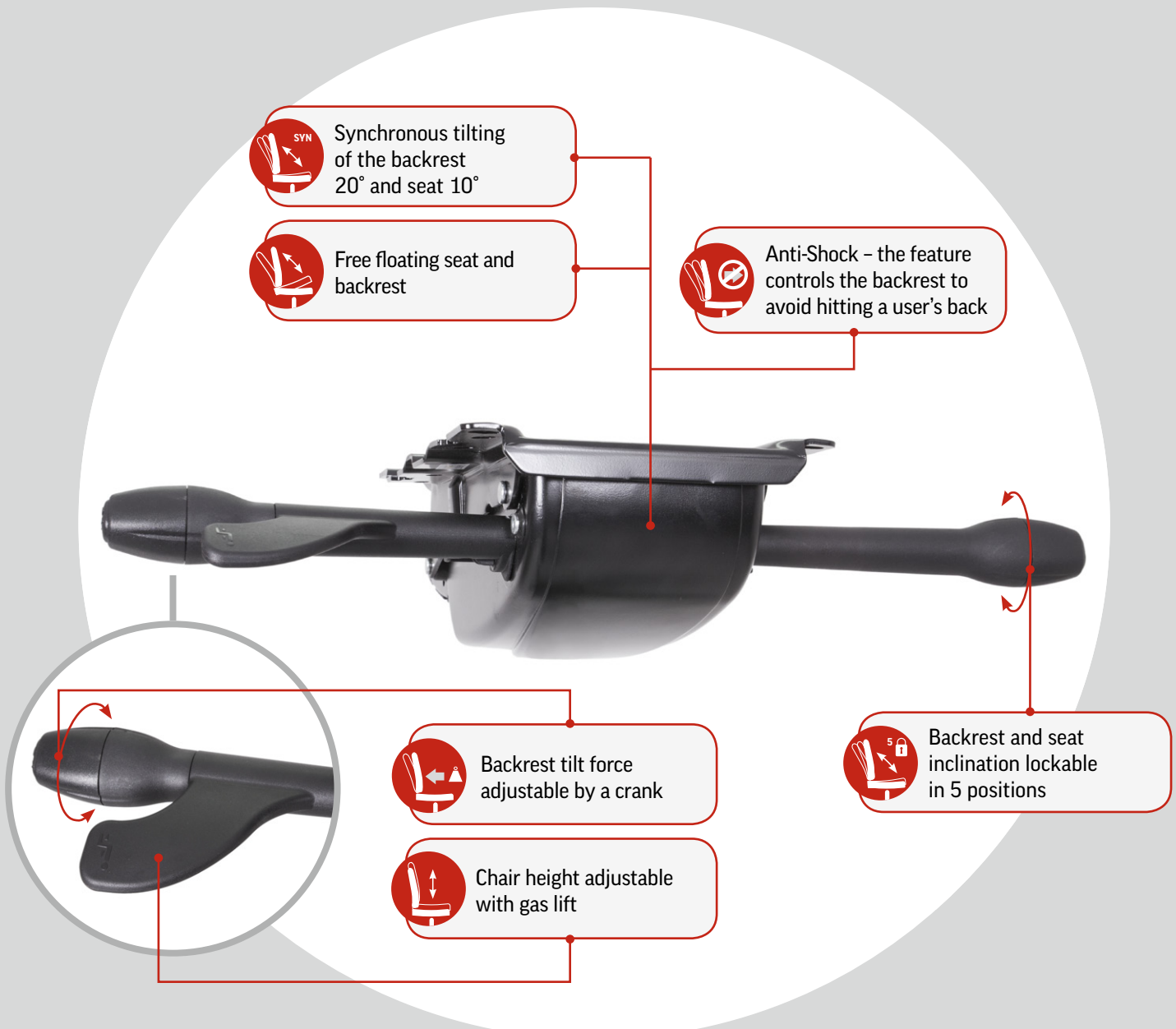

According to Environmental Product Declaration, this mechanism is 99% recyclable.

Examples of chairs with REVO STANDARD mechanism



Diplomat



Kubik



Mojito



Belite

SYNCHRONOUS MECHANISM

REVO STANDARD

with seat depth adjustment



According to Environmental Product Declaration, this mechanism is 99% recyclable.

Examples of chairs with REVO FLEX mechanism



Diplomat



Kubik



Mojito



Belite

SYNCHRONOUS MECHANISM

REVO FLEX STANDARD



According to Environmental Product Declaration, this mechanism is 99% recyclable.

Examples of chairs with REVO FLEX STANDARD mechanism



Diplomat



Kubik



Mojito



Belite

SYNCHRONOUS MECHANISM

REVO FLEX

with seat depth adjustment



According to Environmental Product Declaration, this mechanism is 99% recyclable.

Examples of chairs with REVO FLEX mechanism



Diplomat



Kubik



Mojito



Belite

BIO-DYNAMIC MECHANISM

SELF WITH S-MOVE (For 4ME chair)

- SYN** Synchronous tilting of the backrest 18° and seat 4,5°
- Free floating seat and backrest
- Backrest height adjustment
- AUTO** Automatic adjustment to user weight (from 50 kg to 110 kg)
- Anti-Shock - the feature controls the backrest to avoid hitting a user's back

S-Move



Used as an option e.g. for previously mentioned SELF mechanism.

- Bio-dynamic seating - it moves with the user in 4 directions: when leaning forwards, backwards as well as left and right



 According to Environmental Product Declaration, this mechanism is 99% recyclable.

Examples of chairs with SELF (for 4ME chair) mechanism

